

# Carl F. Bucherer presents its Patravi EvoTec DayDate

## The first watch model with the proprietary CFB A1000 movement

*In 2008, Carl F. Bucherer presented the CFB A1000 calibre. This year, the brand equipped its first watch model with this extraordinary automatic calibre: the Patravi EvoTec DayDate.*

*A specially developed functional module has been added to this outstanding watch from Carl F. Bucherer, whose innovative characteristics extend beyond its exclusive interior to adorn the exterior just as beautifully.*

A new – one might even say revolutionary – chapter in the history of watchmaking began at Carl F. Bucherer in 2005. It was at this time that a momentous decision was taken to crown the company's watchmaking history with a calibre developed and produced by the company itself. The idea of copying an existing movement no longer protected by a patent

was ruled out right from the start. Moreover, the team rapidly opted for an innovative self-winding movement endowed with unique construction features. The resulting CFB A1000 calibre expresses a philosophy heralding a whole new era thanks to creative developments such as the oscillating weight placed on the outer rim, along with innovative techniques such as



*A revolutionary proprietary calibre with peripheral rotor – the CFB A1000 by Carl F. Bucherer.*



*The new Patravi EvoTec DayDate by Carl F. Bucherer.*

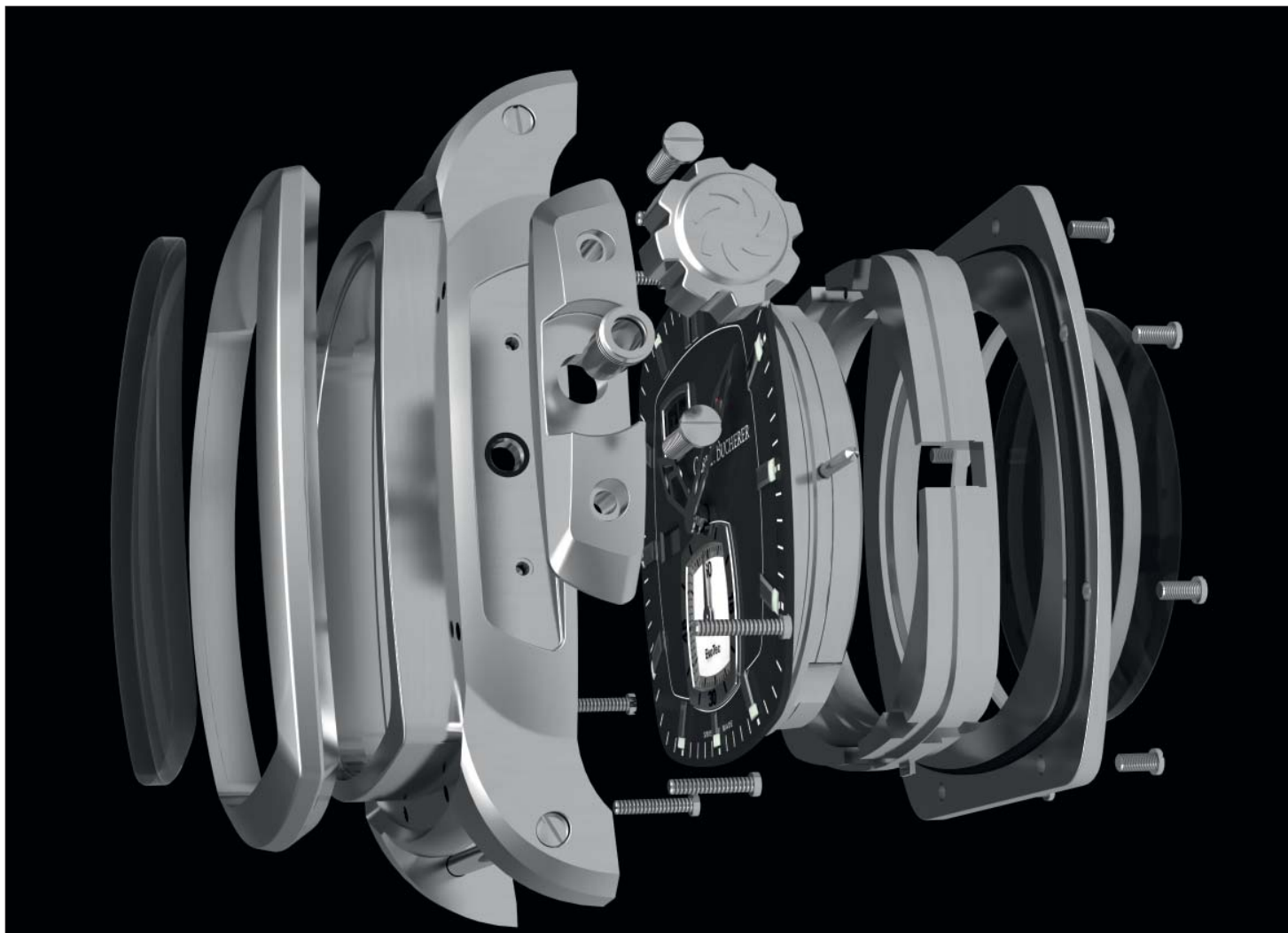

*The EvoTec DayDate fascinates with its sophisticated case – a typical feature of the Patravi line.*

the dynamic shock absorbing system or the fine-adjustment mechanism for which patent requests have been filed.

#### **New case shape for the Patravi line**

The Manufacture's first product, the equally innovative and extraordinary CFB A1000 automatic calibre, needed an appropriate setting once it was ready to go into production and had been fitted with its first specially developed functional module. The striking Patravi line – the undisputed leader within the Carl F. Bucherer collection – offered the perfect solution for the following reasons: firstly, the case with its stylish strap bars and striking crown guards is truly iconic in nature. Secondly, the design is perfectly suited to allow for the development of various shapes, as is impressively demonstrated by the round and barrel-shaped Patravi models.

Thanks to the launch of the new CFB A1001 calibre, based on the CFB A1000

movement, the Patravi line is enjoying remarkable design expansion. The strongly expressive, cushion-shaped case of the Patravi EvoTec DayDate, which is generously proportioned, is the perfect setting for this example of the art of mechanical watchmaking. Its highly acclaimed first public appearance was in an unusual and striking version that featured a small seconds hand at 6 o'clock, which skilfully echoed the shape of the case, a clearly formed day indication at 9 o'clock, and an exuberant big date in the upper-left quadrant of the dial. The dimensions of the latter are sensational, even for a big date display. The geometric index marks echo the slightly convex flanks of the case and underline the deliberately pared-down, modern design concept of the Patravi EvoTec DayDate.

#### **Module for calendar functions**

A module developed in the Carl F. Bucherer workshops drives these

two additional calendar functions. This module is positioned under the impressive dial – in elegant anthracite-grey and black for the stainless steel version, and in warm brown tones for the rose gold model –, on which the distinctive luminous hands turn to count the passing hours and minutes. To ensure that the duo has the smallest possible impact on the indications positioned below, the module has been largely skeletonised.

The time-indication ensemble, i.e. the dial and hands, is framed by a broad rubber bezel. Naturally, both the front and back of the striking yet elegant case feature sapphire crystal. The diameter of the case permits an unimpeded, breathtaking view of a precise and regularly ticking microcosm which is simply the best in its field.

Exactly ninety years after its first watch was released in 1919, Carl F. Bucherer is proud to present a supreme masterpiece of watchmaking art that demon-

strates what entrepreneurial courage, a wealth of original ideas, craftsmanship, and technical skill are capable of achieving seven hundred years after the art of measuring mechanical time was first discovered.

Without doubt, the Patravi EvoTec DayDate is just the first step towards a new era in watchmaking. Faithful to company tradition, the aim of the Carl F. Bucherer team is to produce variety starting from perfect platforms, such as the new CFB A1000 automatic calibre.

